

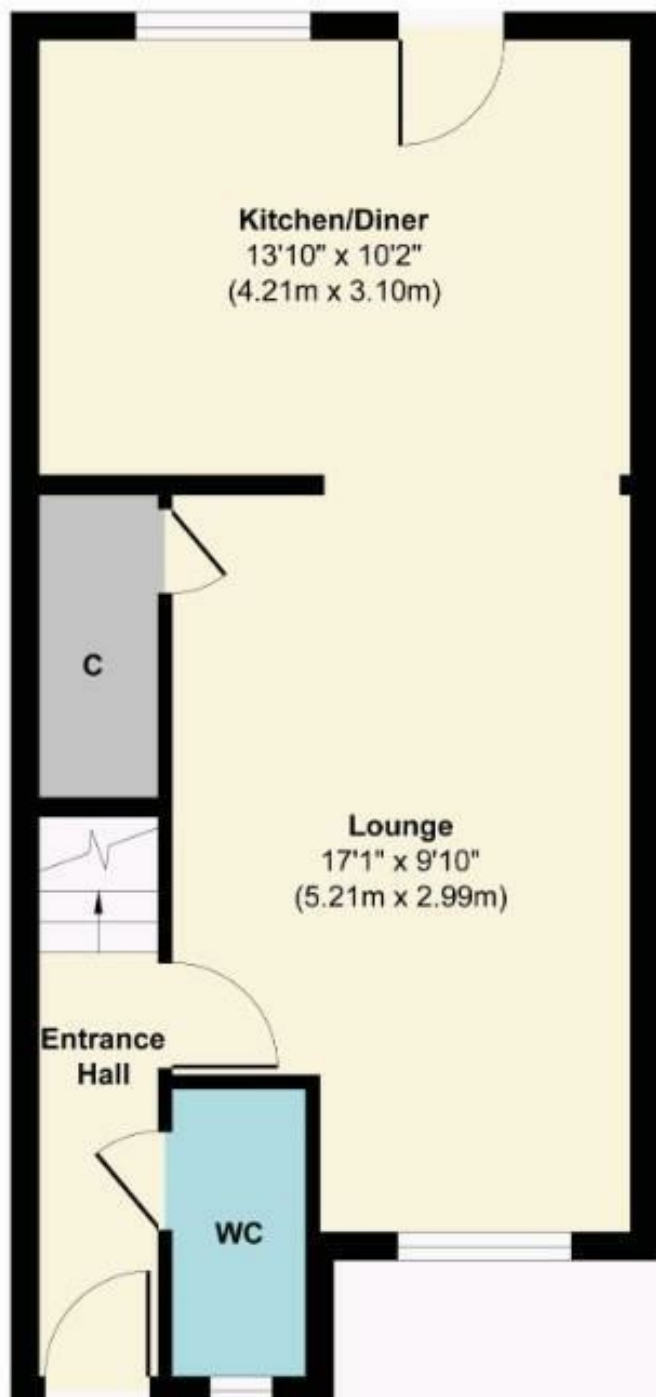

Aldermann McGee Gardens | Great Yarmouth | NR30
 £175,000

abbotFox



Ground Floor

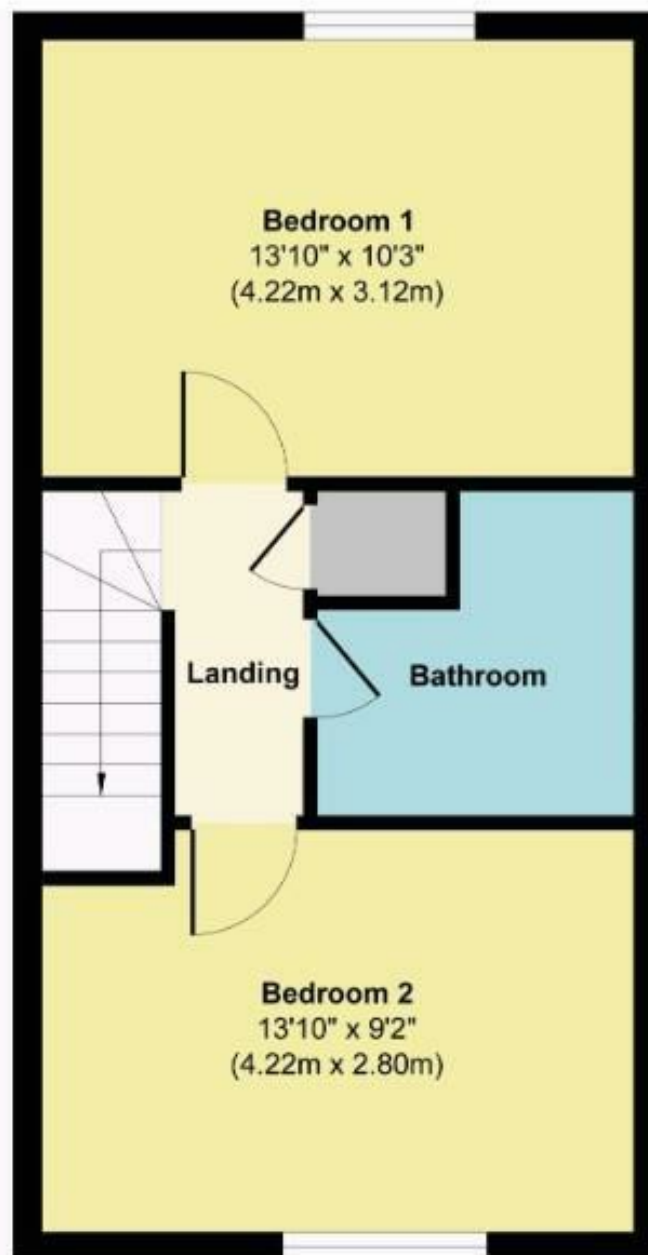

First Floor

Energy Efficiency Rating		Current	Potential
Very energy efficient - lower running costs			
(92 plus) A			96
(81-91) B		84	
(69-80) C			
(55-68) D			
(39-54) E			
(21-38) F			
(1-20) G			
Not energy efficient - higher running costs			
England & Wales		EU Directive 2002/91/EC	

Disclaimer – In accordance with the Property Misdescriptions Act, the company gives notice that all descriptions, references to condition, necessary permissions for use and other details are given in good faith and believed to be correct, but any intending lessees do not rely on them as statements of fact, but must satisfy themselves by inspection or other means, as to their accuracy.



abbotFox Land & New Homes presents this brand new, two bedroom mid terraced home, built by the renowned local builders G&C Homes.

Offering a bright and stylish finish throughout, this home represents an ideal opportunity for any first time buyer. On the ground floor, an inviting entrance hall, with cloak WC, opens up onto a spacious lounge, perfect for entertaining, and then leads to a stylish kitchen diner. The first floor comprises two double bedrooms and a family bathroom. Externally, this home enjoys an enclosed rear garden and parking for two vehicles.

Located in Great Yarmouth, this property is ideally situated for those looking to enjoy a vibrant coastal town with a rich history and culture. The town offers a wide range of amenities, including shops, restaurants, bars, and entertainment options. An internal viewing comes highly recommend.

Agents Note: Please be aware the images are taken from a previous development of the same house type

